

XLOCK Handle H30

INSTALLATION

X LOCK



PACKAGING LIST

Number	Name	Quantity
1	Front panel	1
2	Back panel	1
3	XLOCK Key fob	3
4	Waterproof rubber plate	2
5	U-Clip	1
6	60 mm square shaft	2
6	80 mm square shaft	2
8	M4 *40 mm screw	4
9	M4 *50 mm screw	4
10	M4 * 60 mm screw	4
11	M3 * 8 mm screw	3
12	Mechanical key	2
13	Hexagon	1
14	Hexagon screw for handle fixation (spare part)	2

! Attention !

Please order the battery
separately.



4 x AAA Energizer Lithium Batteries
Always use Lithium batteries!

MEASUREMENTS

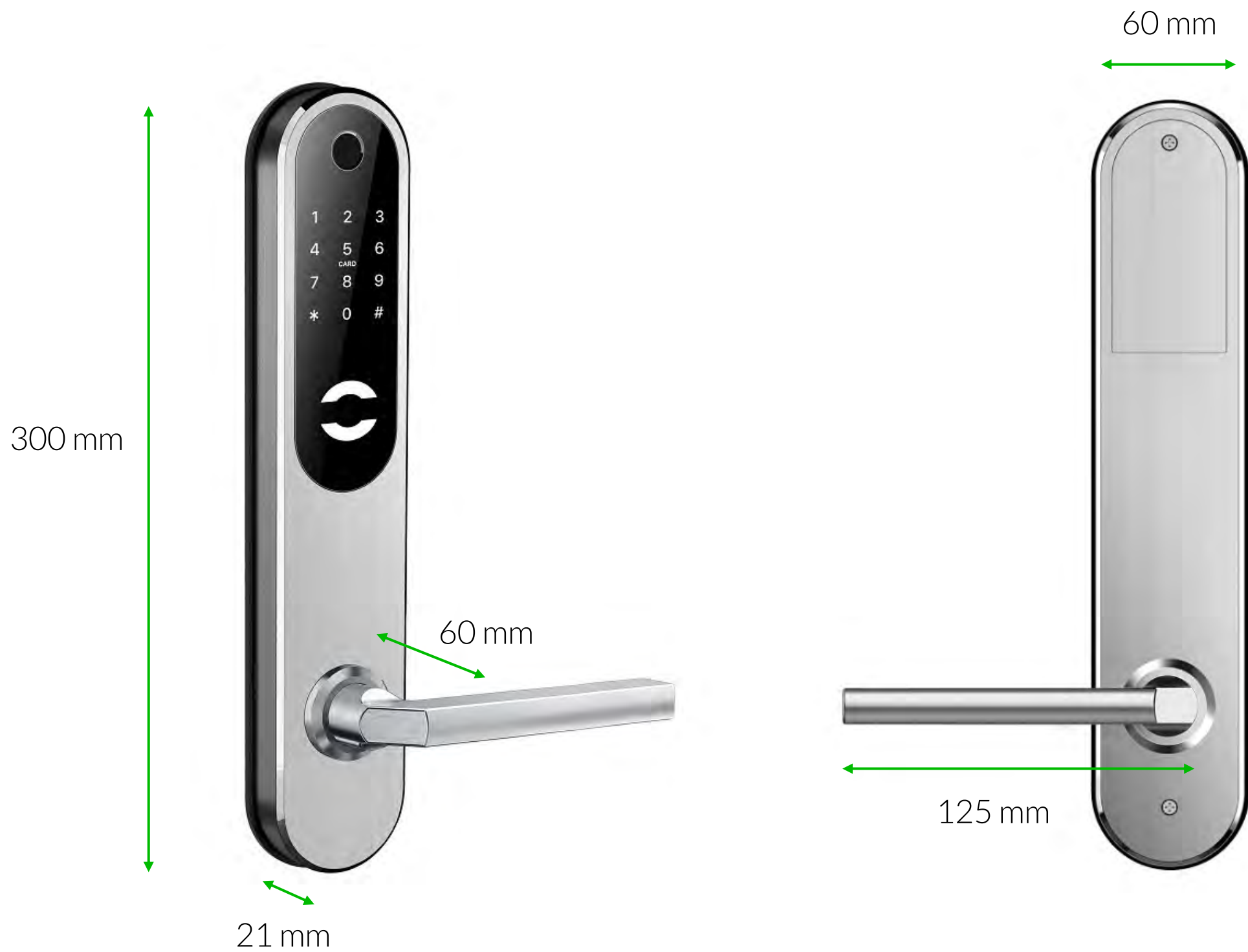

PREPARATIONS OF THE LOCK



4 x AAA Energizer
Lithium Batteries
For error-free operation,
please always use lithium
batteries!

Insert the batteries with
the correct polarity +/-
in the back panel.



Your lock is now ready
for use and can be
programmed in the XL
Lock Manager App.

PREPARATIONS OF THE LOCK

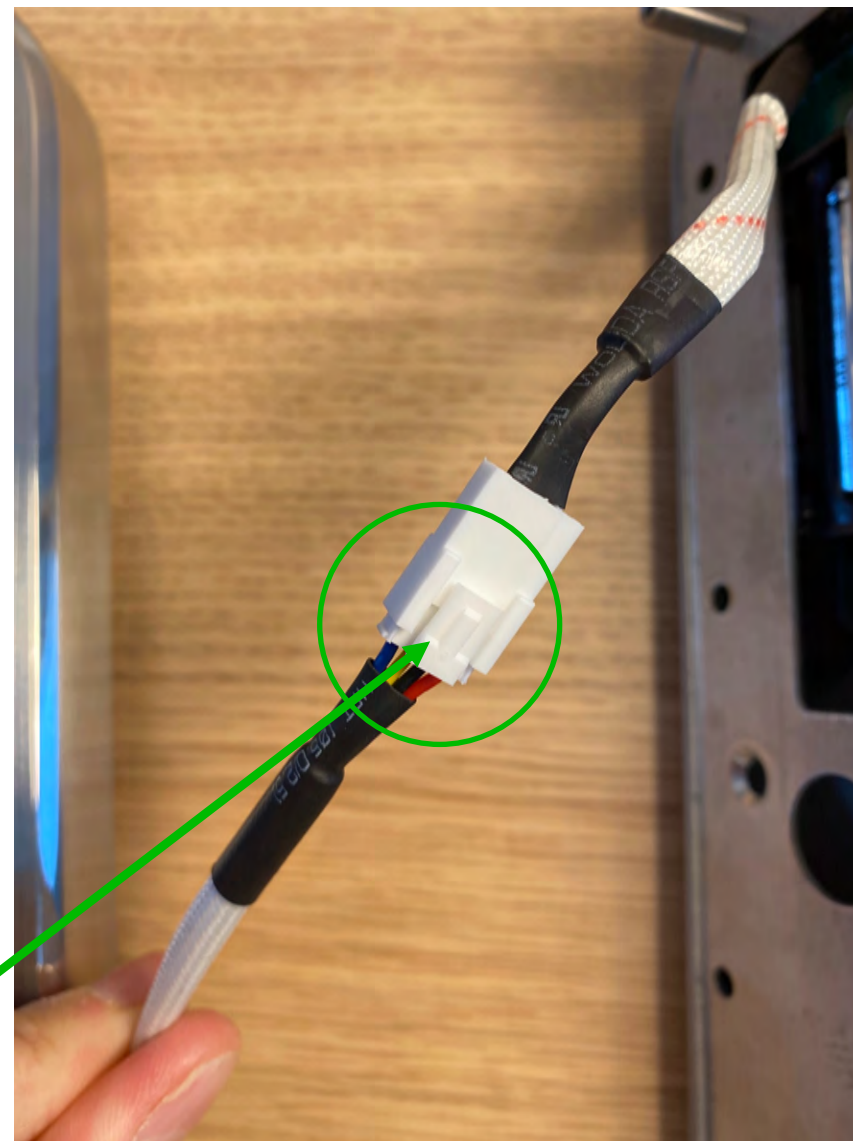

Connect the cable.

INSTALL THE APP AND CREATE AN ACCOUNT



XL Lock Manager

Download the app and install it on your smartphone (iOS + Android).

Scan QR Code with the camera of your smartphone and press the link:



After installation, create your XLOCK account and confirm in the e-mail.

! ATTENTION WITH ANDROID DEVICES !

With Android devices, the following authorizations must be granted without restrictions for the commissioning of Bluetooth devices:

Location and Bluetooth

In retrospect, this is no longer possible with some devices. Then you have to uninstall and reinstall the app and then restart the device.

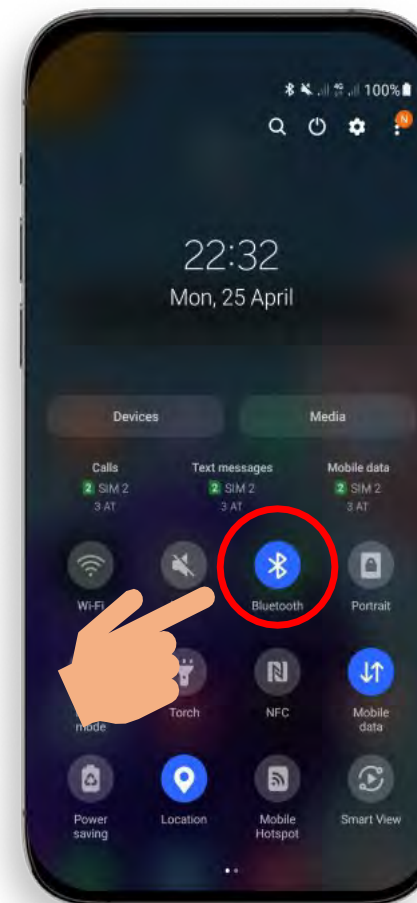

For the programming of an XLOCK lock, the **location** and **Bluetooth** must be activated on your Android device!

CREATE ACCOUNT

1

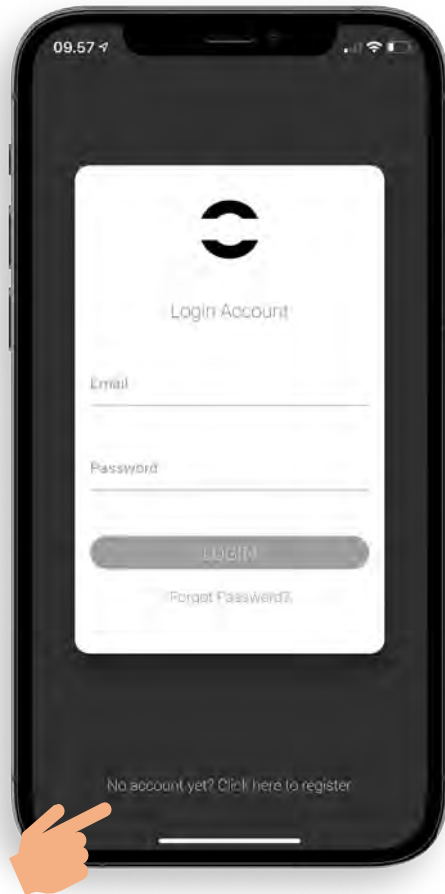

1. Press the button shown above.
No account yet? Click here to register.

2



2. Enter your email address and choose a password.
To confirm, insert the password a second time.
Click Register.

3

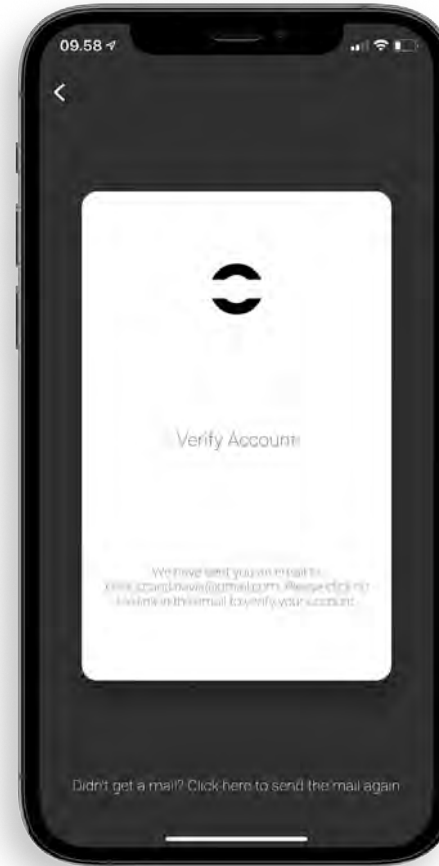

3. Verify your account by clicking on the confirmation link in the XLOCK email in your inbox.
The confirmation email may have ended up in your spam folder.

4

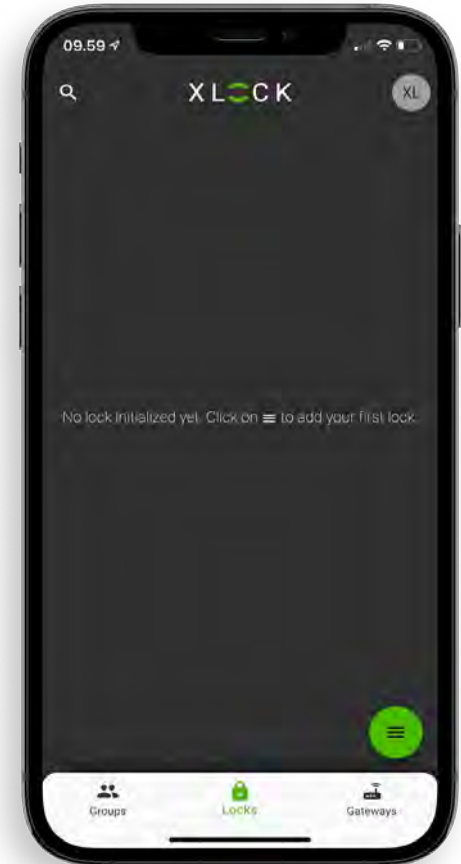

4. Congrats! You have successfully created a XLOCK account.

PROGRAMM THE LOCK IN THE APP

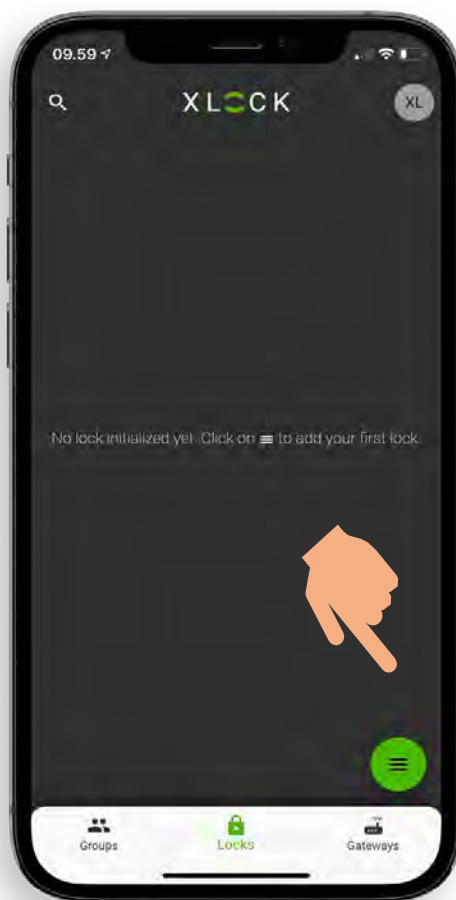

1. Tap the button at the bottom right corner.

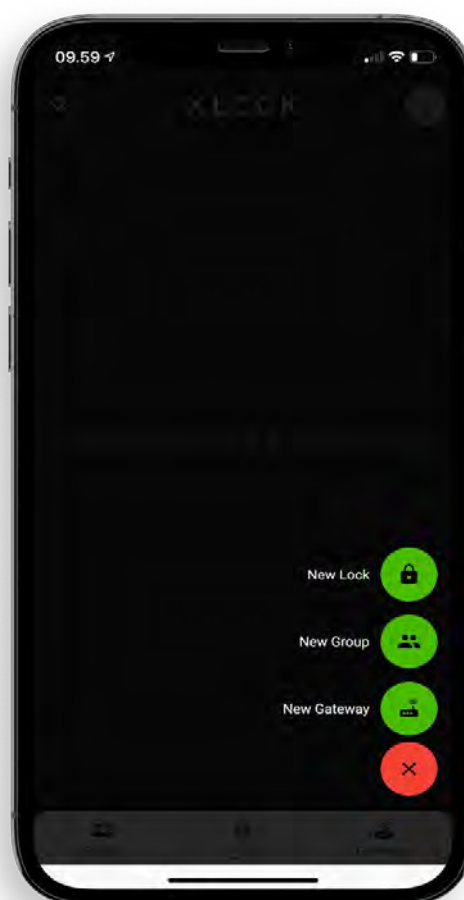

2. Press NEW LOCK.



3. Have the XLOCK ready. Press and hold the Reset Button with a screwdriver for 5 seconds. A long sound arises.



4. The lock is displayed with its ID number. Tap the green symbol as shown above to add your XLOCK.*

*The lock might ask for an initialization password. Please press "000#" to complete the initialization.

PROGRAMM THE LOCK IN THE APP

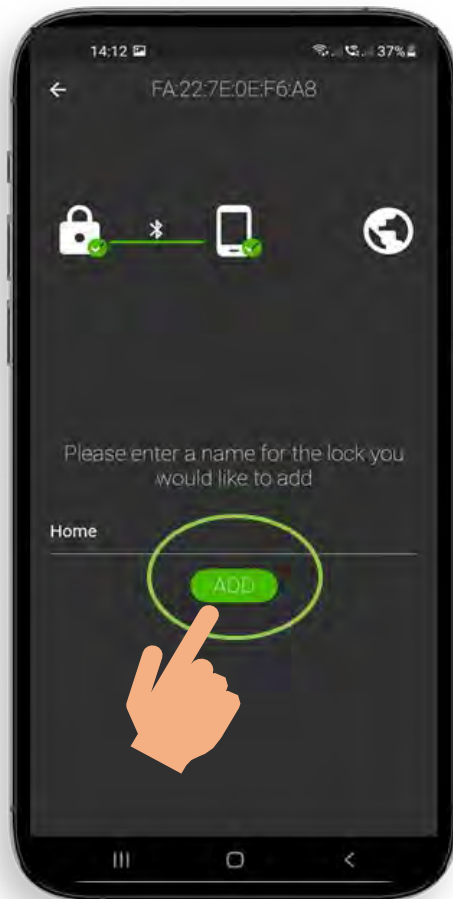

5. Insert a name for your XLOCK and press ADD.



6. The XLOCK has now been successfully programmed to the XLOCK APP and is visible on your start screen.

HANDLE DIRECTION (FRONT PANEL)



YOU NEED THE TOOLS
SHOWN ABOVE (All included in
the set).



1. Turn the handle on the front
panel. Loosen the inner hexagon
screw of the handle
counterclockwise.

HANDLE DIRECTION (FRONT PANEL)



2. Remove the handle.

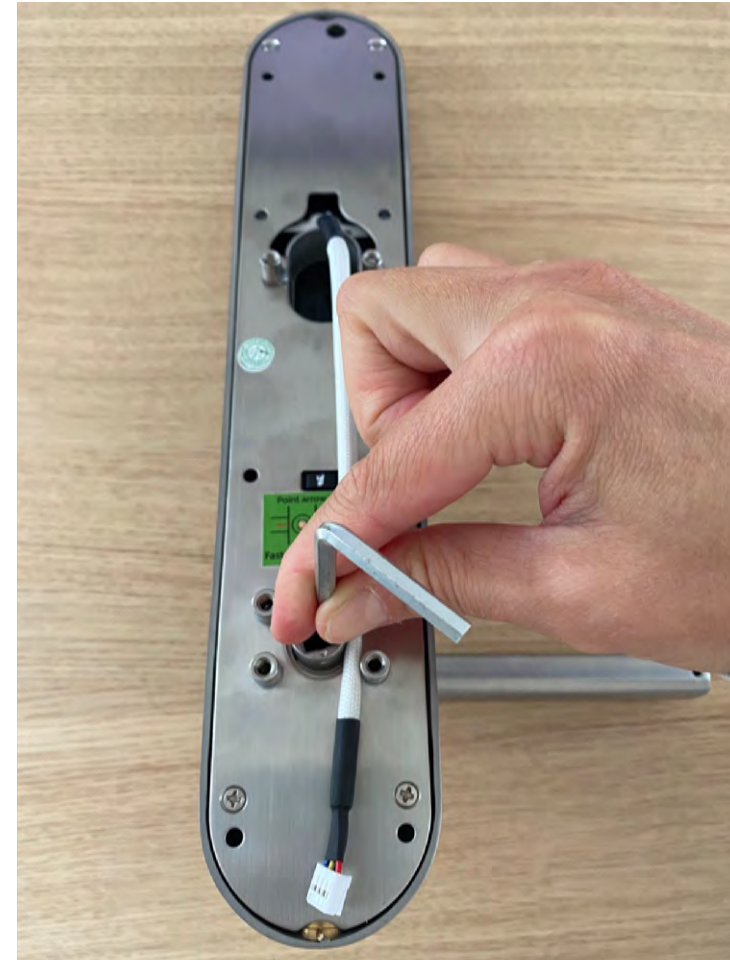

3. After adjusting the direction of the handle, insert it into the handle seat and re-lock the hexagon screw of the handle to the complete the turning.

HANDLE DIRECTION (BACK PANEL)



YOU NEED THE TOOLS
SHOWN ABOVE (All included in
the set).

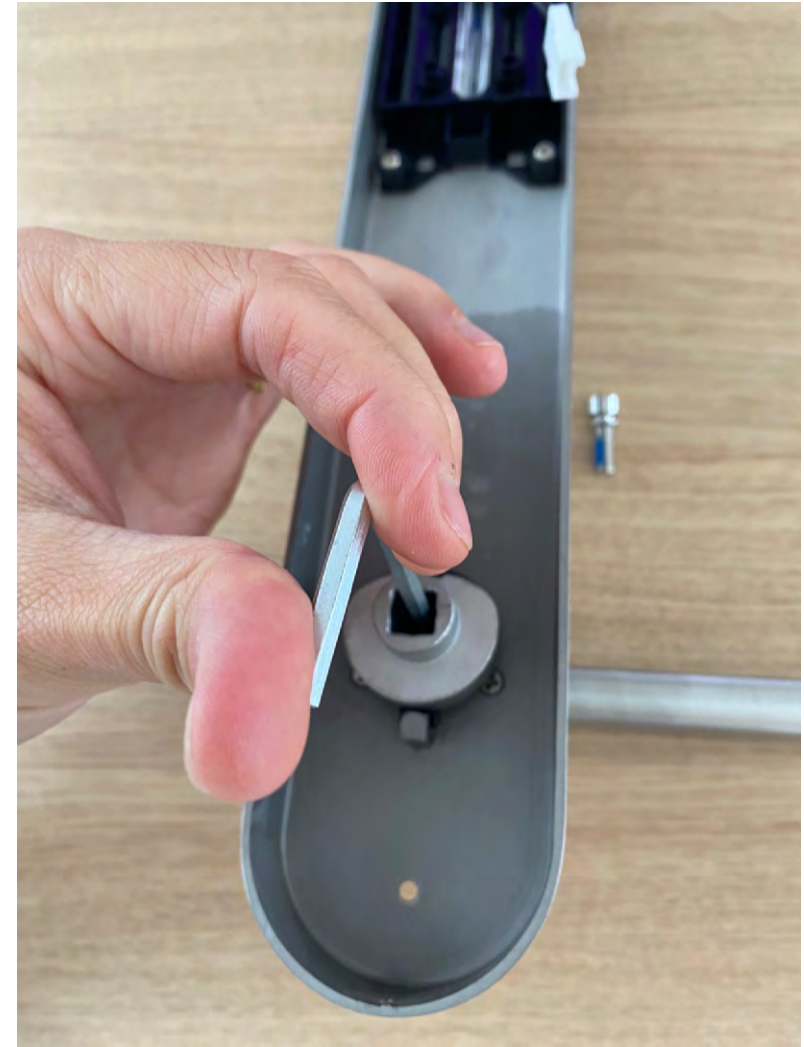

1. Turn the handle on the front
panel. Loosen the inner hexagon
screw of the handle
counterclockwise.

HANDLE DIRECTION (BACK PANEL)



2. Remove the handle.



3. After adjusting the direction of the handle, insert it into the handle seat and re-lock the hexagon screw of the handle to the complete the turning.

DEMOUNT THE EXISTING MECHANICAL LOCK



FIND RIGHT LENGTH OF SQUARE SHAFT



XLOCK TIP: This is a very important step! As this square shaft is the part that connects the front and back panel. Check page 23 for more detailed pictures of the installed square shaft.

INSERT AND MOUNT THE SQUARE SHAFT IN THE FRONT PANEL



Make sure the rubber plate is installed on the front panel.



To secure the square shaft it is **very important** to bend the u-clip with the help of a screwdriver.



THE ARROW NEEDS TO BE POINTING DOWN



To secure that the motor of the lock is working properly, the arrow always needs to be pointing down when installing!

INSTALL THE FRONT PANEL



! The cable needs to get through this hole in the mortise lock to connect with the back panel !

POSSIBLE ADJUSTMENT



In some cases you might need to drill a bigger hole in the mortise lock to fit the cable through.

INSTALL BACK MOUNTING PLATE



Make sure the rubber plate is installed and that the cable is through to connect with the back panel.

Use your hand to hold the front panel and the back mounting plate together.

A total of FOUR opposite pull screws need to be locked. The bottom pull screw determines which two screws to lock according to the hole position the lock body can pass through.



XLOCK TIP: In some cases the screws need to be adjusted to the thickness of the door. The screws can be cut with a metal saw.

POSSIBLE ADJUSTMENT



In some cases you might need to adjust the length of the square shaft. This can be done with a metal saw.

CONNECT WIRE AND INSTALL BACK PANEL



Connect the cable from the front panel with the cable from the back panel.

LENGTH OF SQUARE SHAFT



IMPORTANT: The square shaft should not be too long or too short.

Too long: You cannot insert the back panel fully.

Too short: The interior handle will not be able to open.

After installation please check that the interior handle works well.

FASTEN BACK PANEL

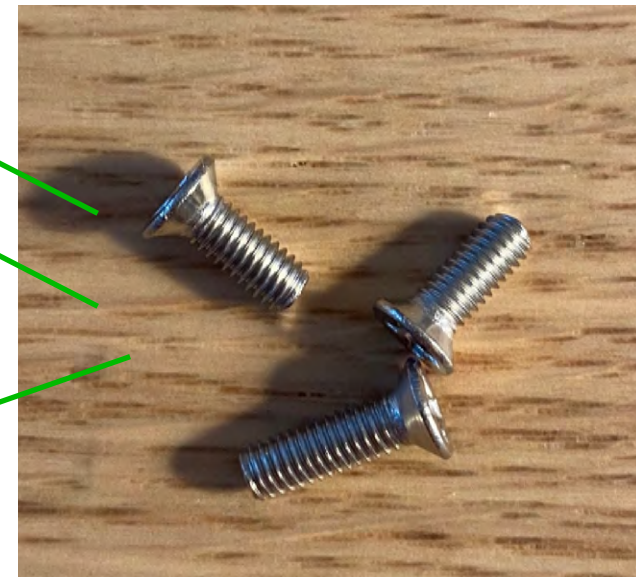
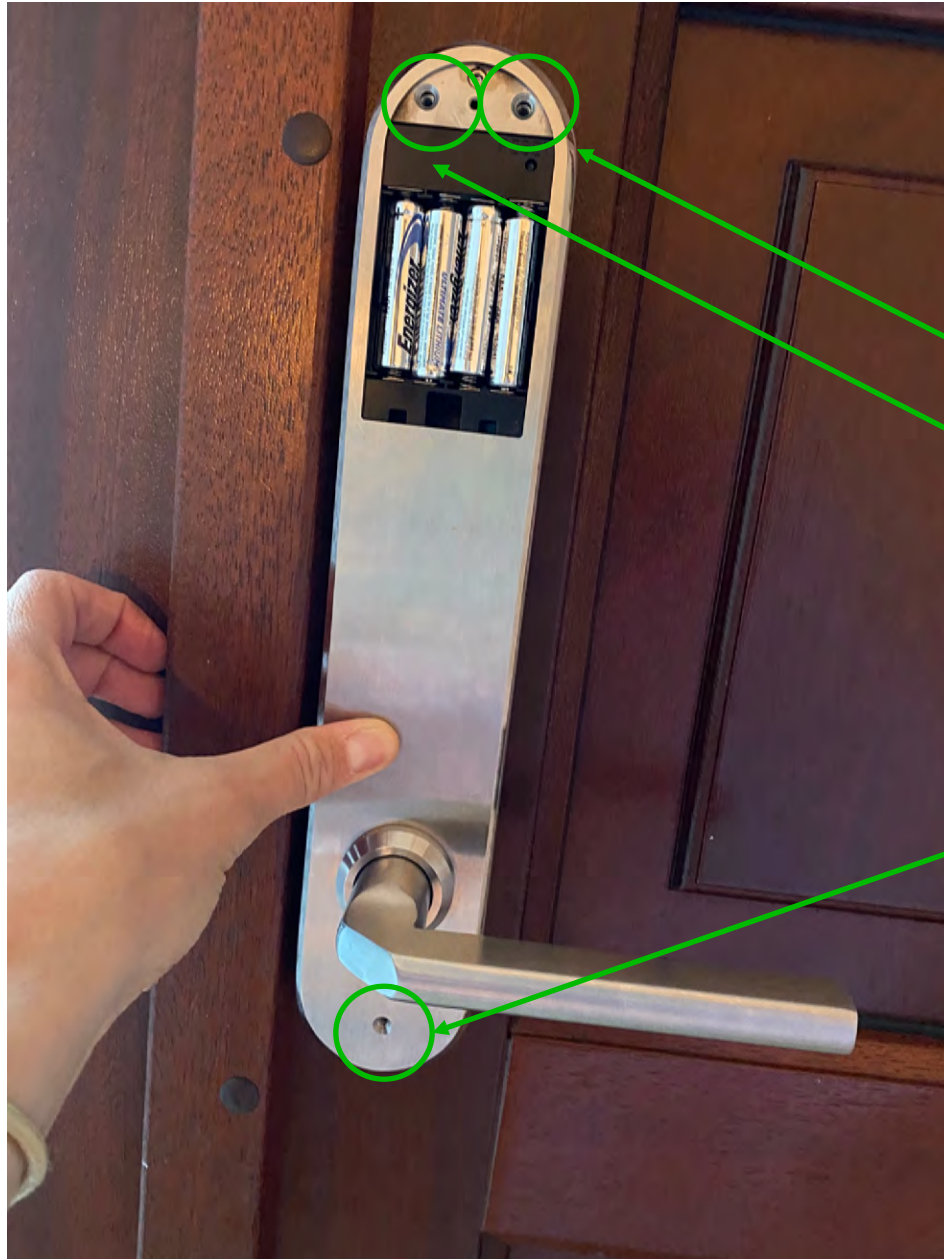

CLOSE BATTERY COVER

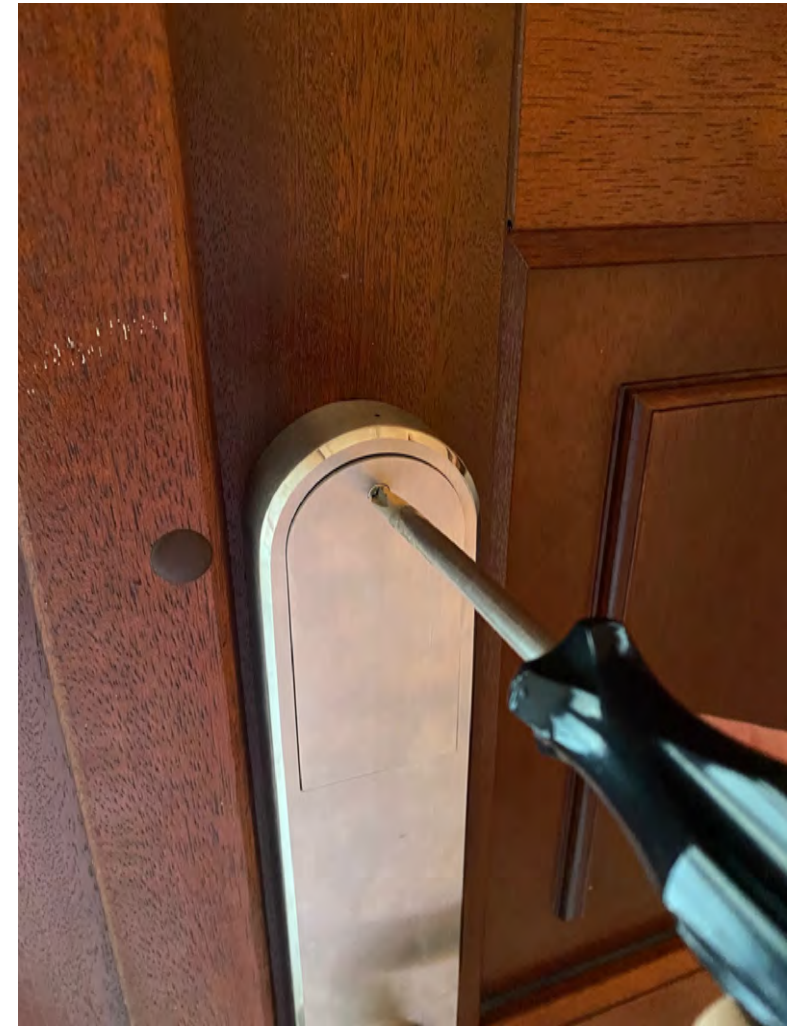

(UN)LOCK YOUR LOCK VIA BLUETOOTH



Unlocking with the smartphone and the app is very easy. A swipe to the right unlocks the lock. The reading distance is up to 15 meters. The lock can therefore also be hidden, e.g. installed behind a locker front, invisible. Toggle mode (open/close function) can also be used with the smartphone. This function is activated and deactivated in the lock settings.

GATEWAYS

! OPTIONAL ! Please order separately.



XLOCK Gateway G2-WIFI incl.
USB C charging cable.
2.4 GHz WIFI compatible
USB power adapter required



XLOCK Gateway G3 Ethernet
incl. USB C charging cable
USB power supply required



XLOCK Gateway G3 POE Ethernet
incl. USB C charging cable
POE does not require a
separate power supply

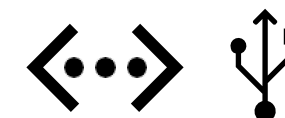

BLUETOOTH ACCESSOIRES

! OPTIONAL ! Please order separately.



The lock can be unlocked over a distance of up to 15 meters with the BLE Remote key - wirelessly.

All other functions such as unlocking and locking with a transponder, PIN Code or with a smartphone continue to work.



XLOCK BLE
Remote key

CR232 Lithium



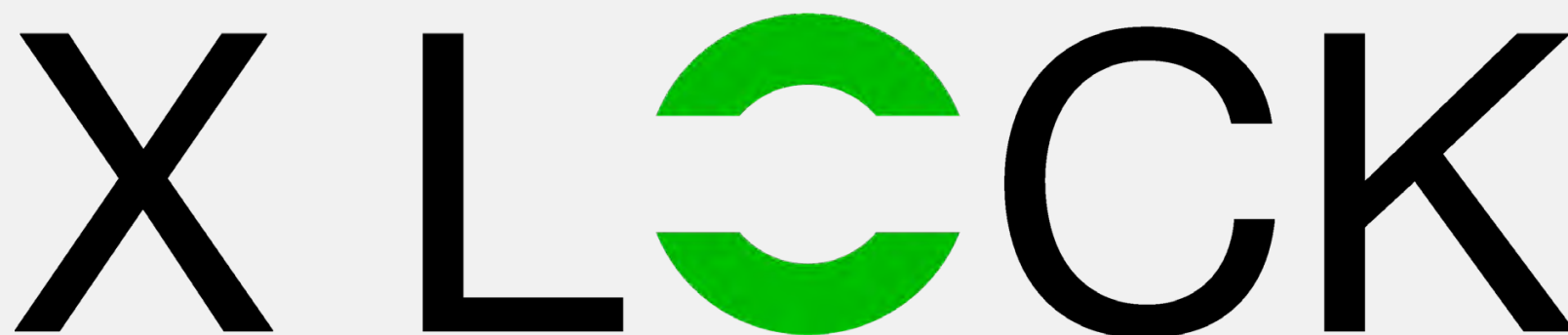

For more information and support
please contact the XLOCK partner you purchased your
XLOCK Handle H30 from.

XLOCK Scandinavia ApS

Bryghuspladsen 8

DK – 1473 Copenhagen

info@xlockgroup.com

www.xlockgroup.com